

THE HAVOC — HISTORY IS A SYMPHONY OF DIFFERENT MELODIES . . .

HAUNTED HISTORY

THE GHOSTS OF ROCK ISLAND ARSENAL'S QUARTERS ONE

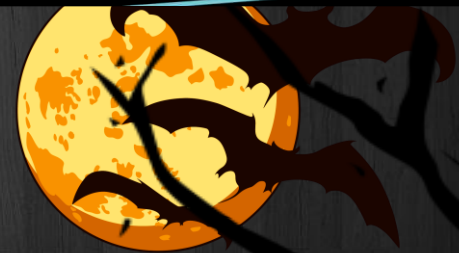

SATURDAY, 09 OCTOBER 2020 @ 1800-1900 CDT
VIA TWITCH.TV @HISTORYKID

PRESENTED BY: **THE KID**

[@HISTORYKID](#)

WWW.MELODICHAVOC.COM

[facebook/MELODICHAVOC](#)

[tumblr.@MELODICHAVOC](#)



THE PIKE EXPEDITION

1804



Portrait drawing of Zebulon Pike ca 1808.

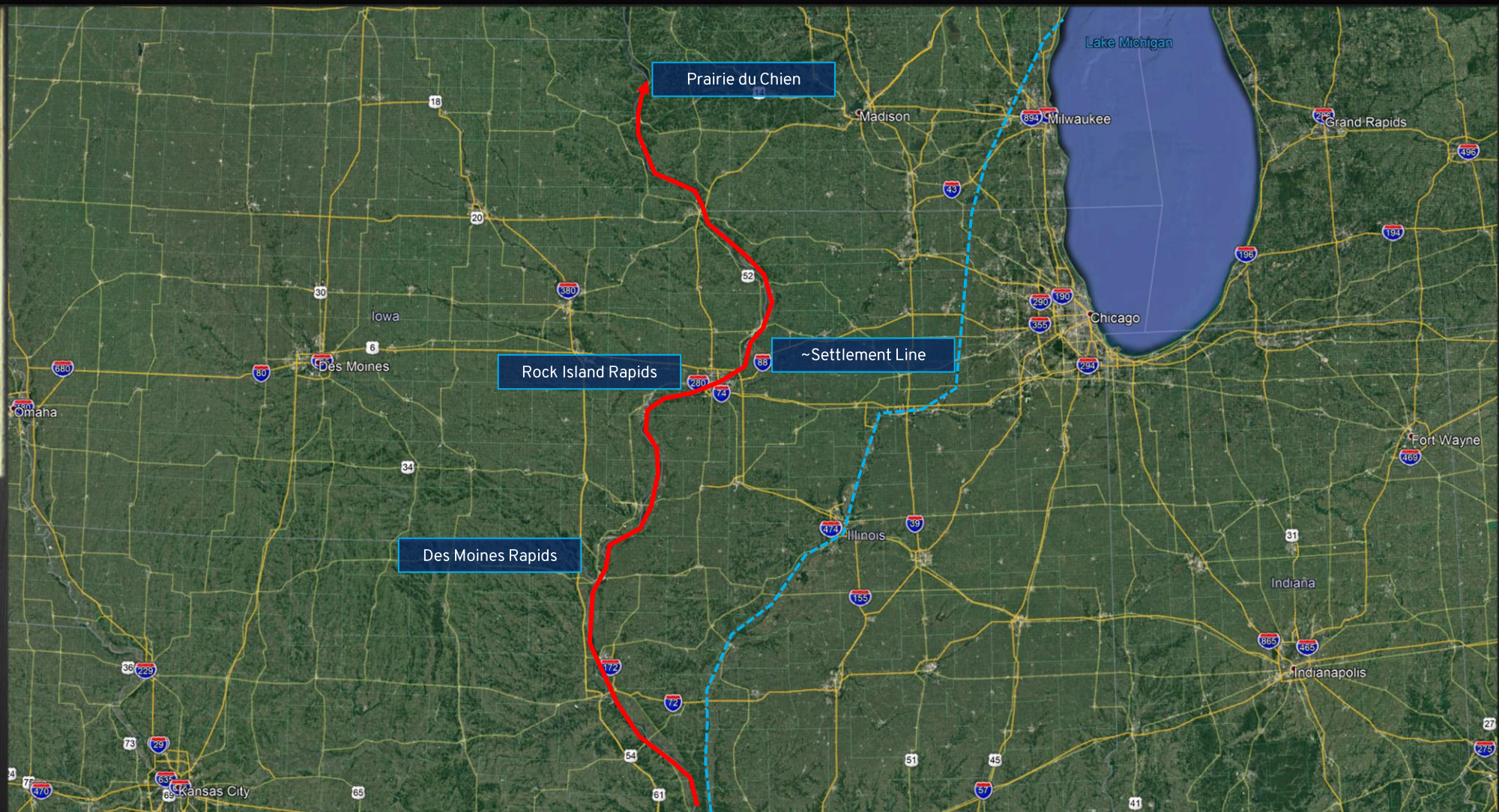



THE PIKE EXPEDITION

1804

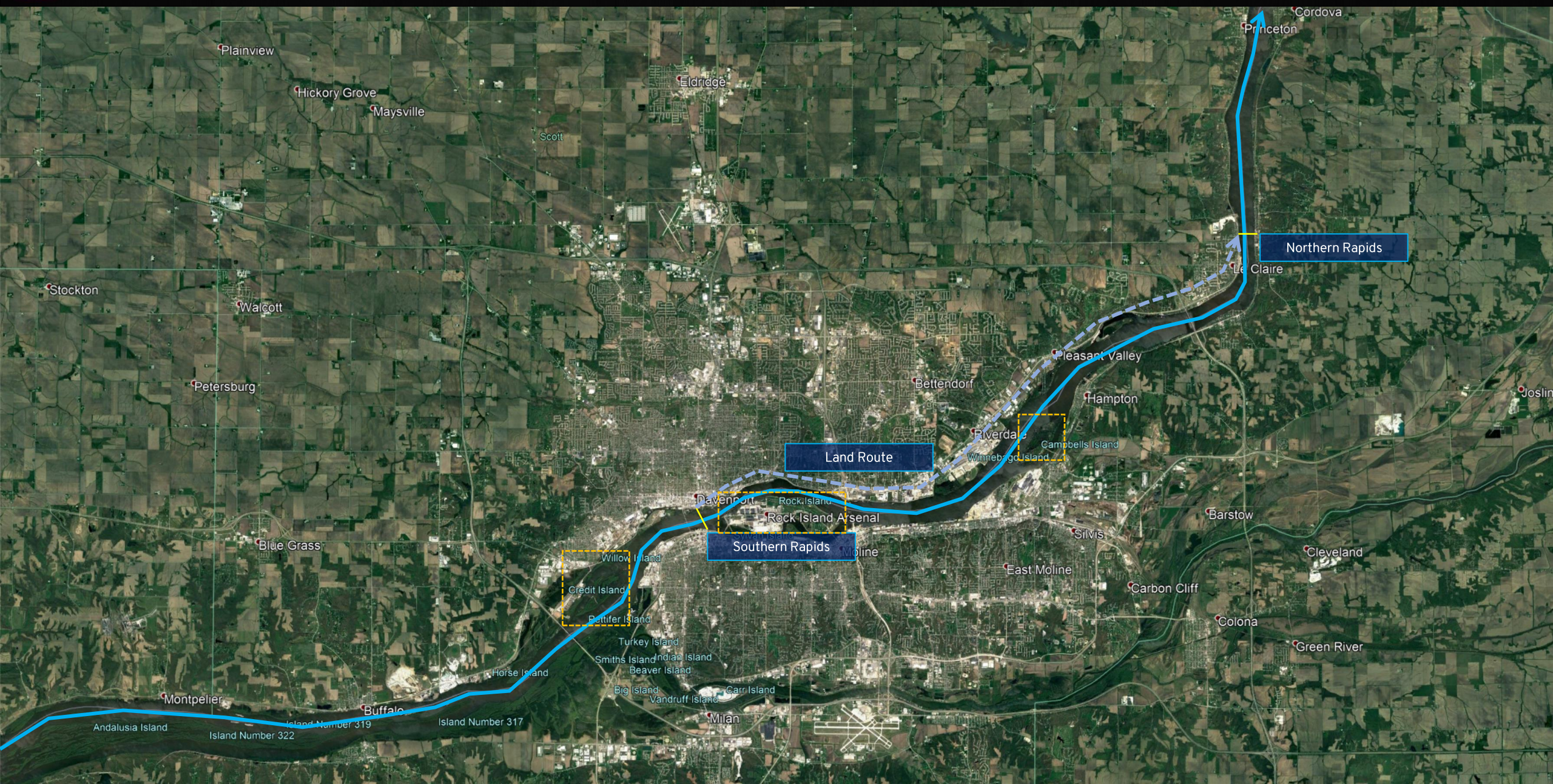



THE ESTABLISHMENT OF FORT ARMSTRONG

1816

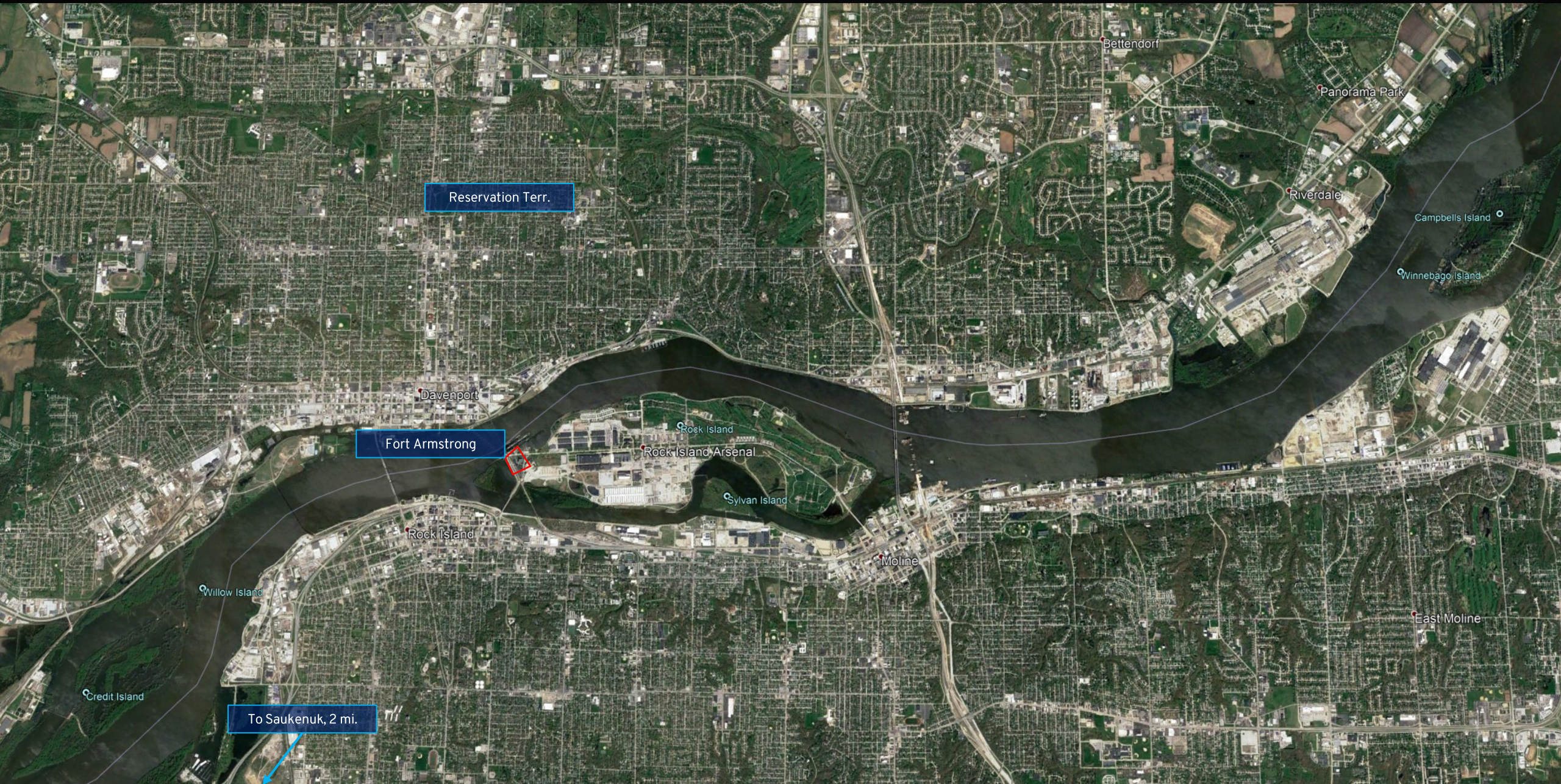



THE BLACKHAWK WAR

1832

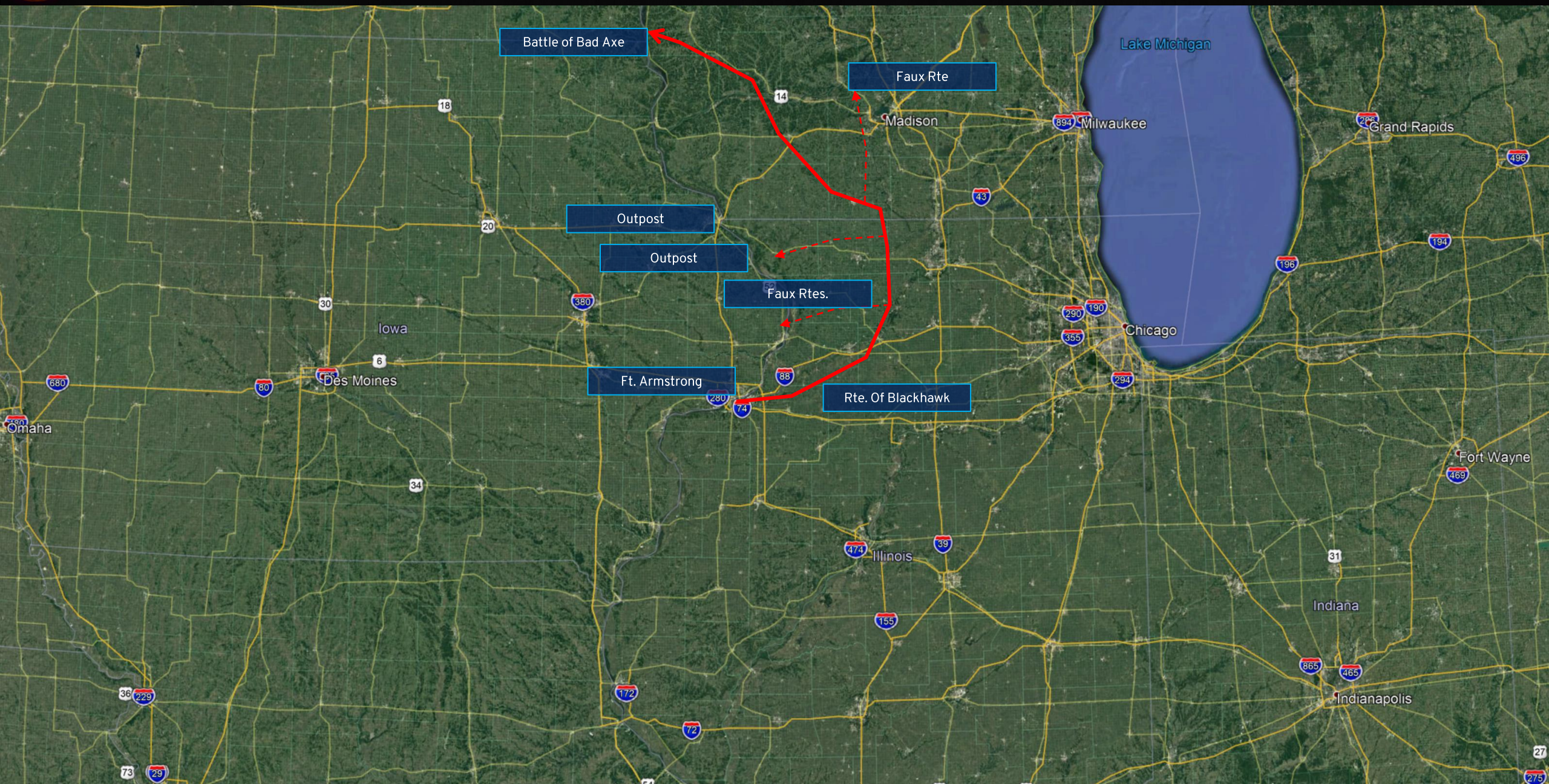



PLAT of ROCK ISLAND, ILL'S.
in Township 18 N. Ranges I & II West.

PLATE. V.

Scale: 3000 500 0 2000 3000 ft

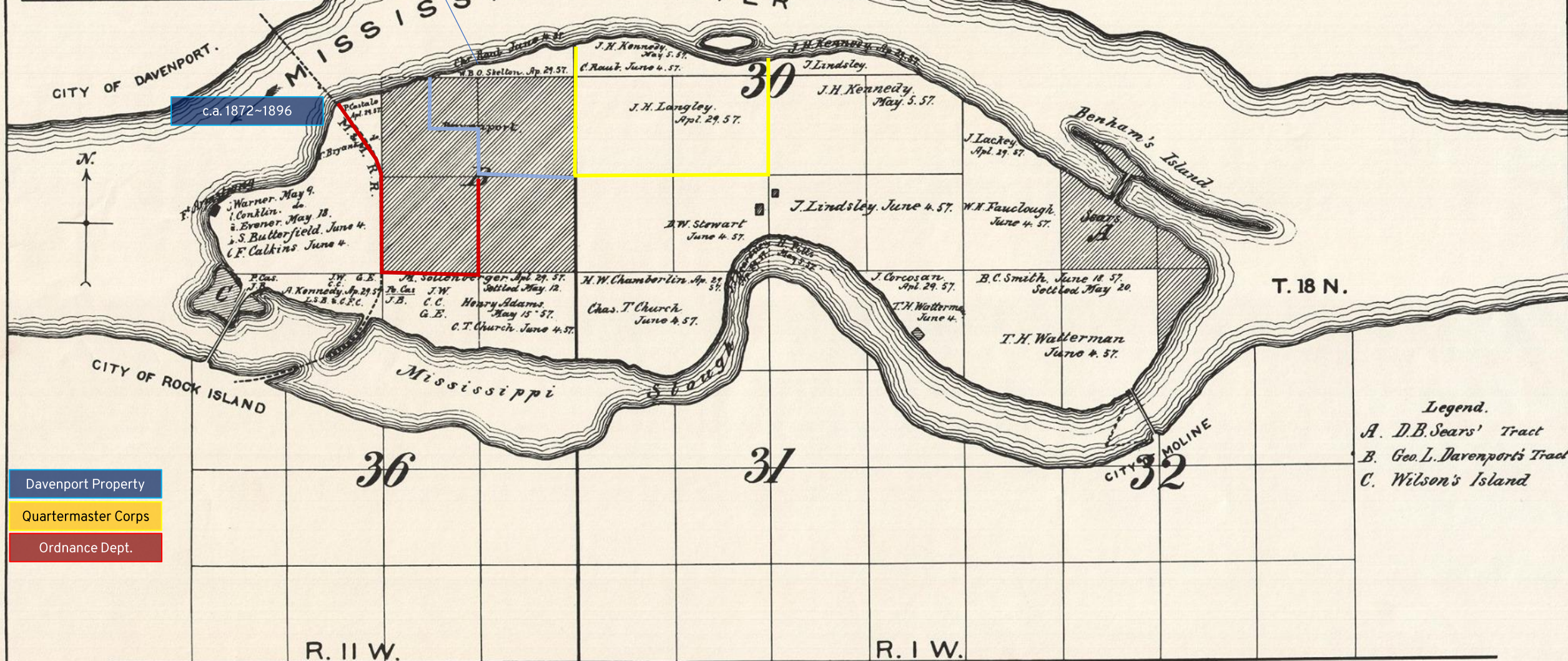

Davenport Property

Quartermaster Corps

Ordnance Dept.

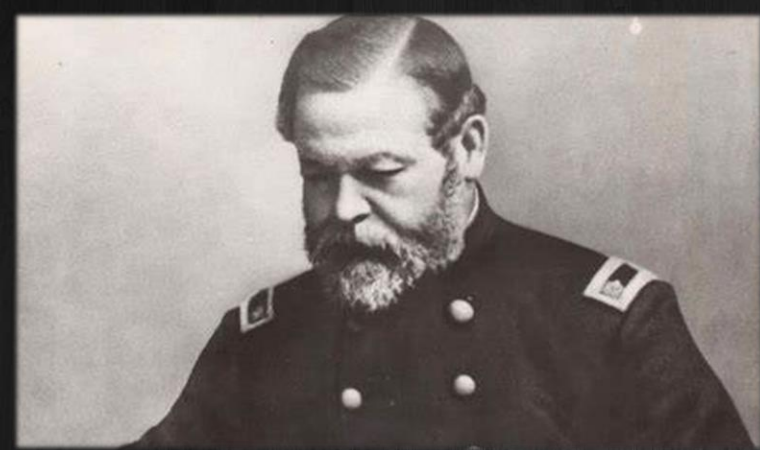

Had been the commanding officer at Watertown Arsenal.

Was brought up on four charges post-Civil War:

1. Allowing men to drink whiskey at lunch.
2. Did not mourn Lincoln's death enough.
3. Did not celebrate the end of the war enough.
4. Overspent (~\$2,350) on budget for Watertown Quarters.

RODMAN IS SENT OUT WEST, IN 1865, TO ROCK ISLAND ARSENAL.

Rodman planned for Rock Island Arsenal to be a grand national arsenal.

The plan called for moving of the original arsenal facilities to the center of Rock Island island.

Streamlining of facilities included quarters and cemeteries.

Ten stone shops would make up the core of the arsenal: Arsenal and Armory Rows (north and south respectively).

But you still need quarters befitting a commander of a grand national arsenal, and a place to house/entertain guests...right?





- Constructed between 1869-1871.
- Grounds completed in 1872.
- Used Joliet Limestone materiel.
- Walls are two feet thick.
- Same limestone as the shops used.
- A “modest” 20,000 square foot home.
- Second in size only to the White House.

Justification for size:

1. A place to house guests.
2. A place to house travelling soldiers.
3. A federal courthouse.
4. A place to entertain visitors.
5. Reflective of the grandeur of the arsenal.

- Cost is unknown.
- Used arsenal workers for construction efforts.



QUARTERS ONE: THE BASEMENT

1871

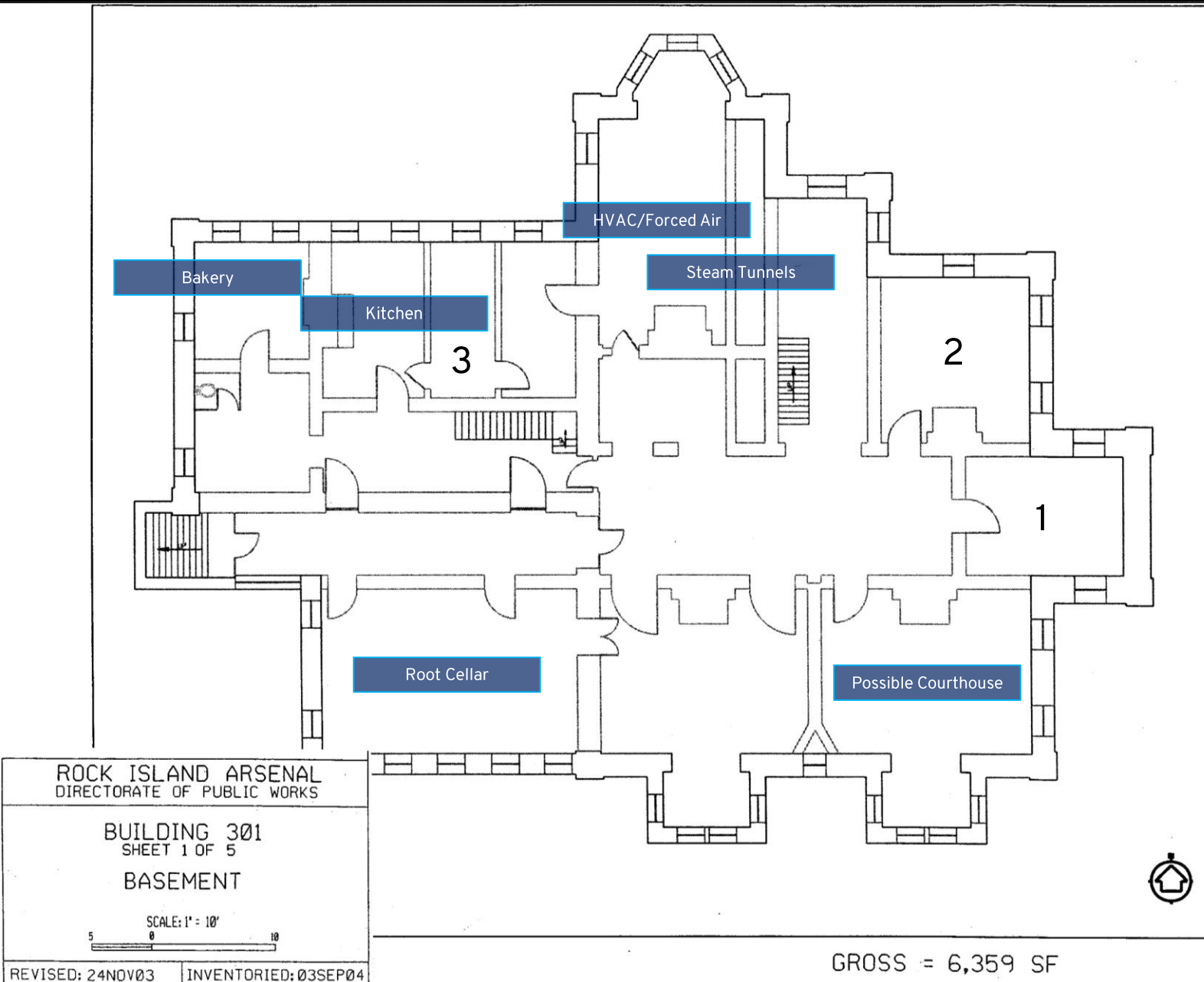

- Has two stairways original to house.
- One additional stairway added later.
- Majority of rooms are storage space.
- Original kitchen and bakery.
- Original limestone counters still in place.
- Potential site of courthouse.
- Still has original forced air system.
- Root cellar located directly under old greenhouse.
- Storage rooms to the north and east had openings for fireplace cleaning.
- Has several “creepy rooms” and “odd sensations.”



QUARTERS ONE: FIRST FLOOR

1871

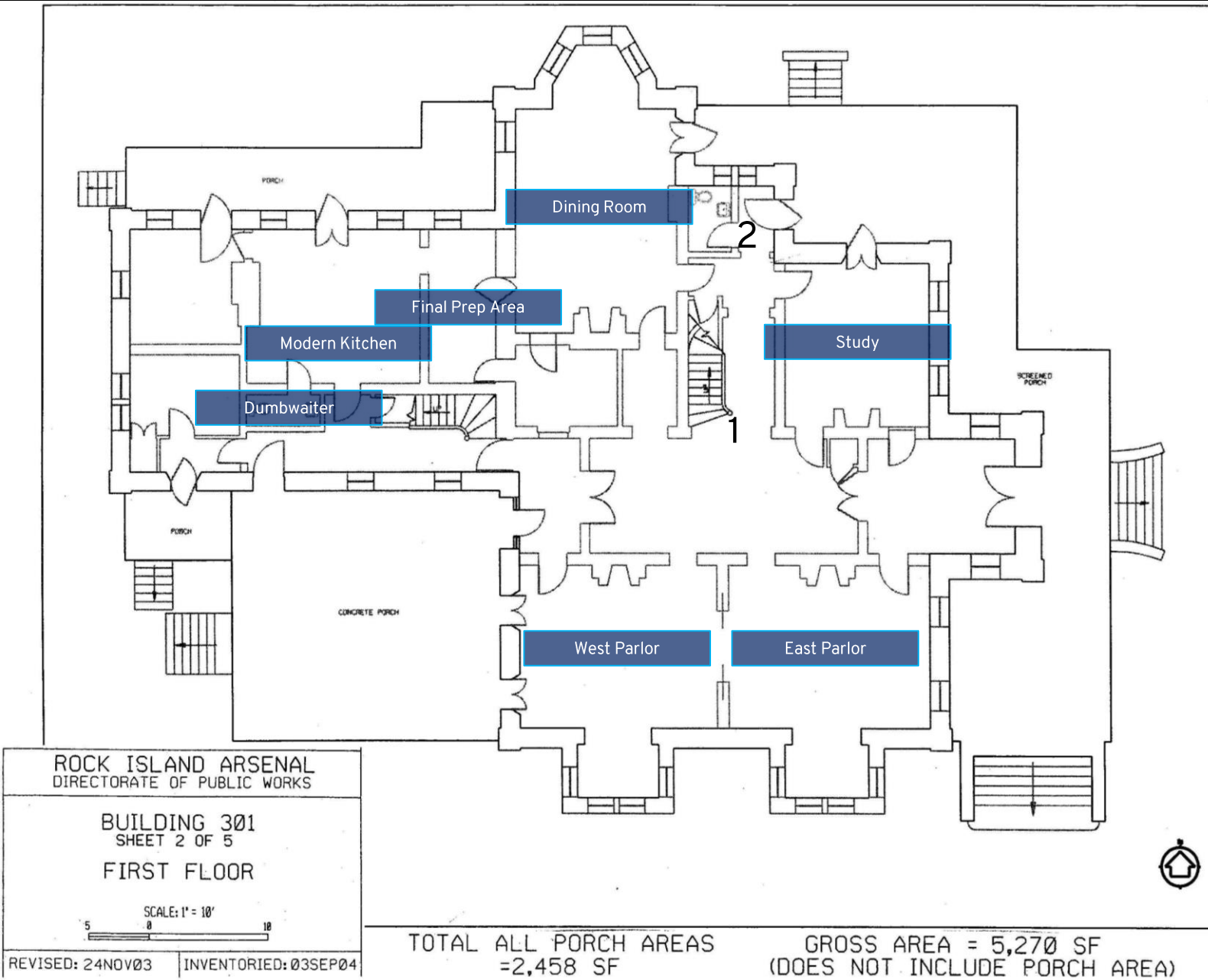

- The decorative iron and brass around the front is made from Civil War ordnance.
- Floors are original polychrome oak and walnut in the front half of the house.
- Ceilings are 16 feet high in front.
- Cast iron cornices.
- Fireplaces are all Italian marble.
- Brick in the Study.
- Some furniture built in the wall is original.
- Lots of natural light.
- Rodman dies in his study in 1871.
- First public gathering at Q1 in parlors is Rodman's funeral.



QUARTERS ONE: SECOND FLOOR

1871

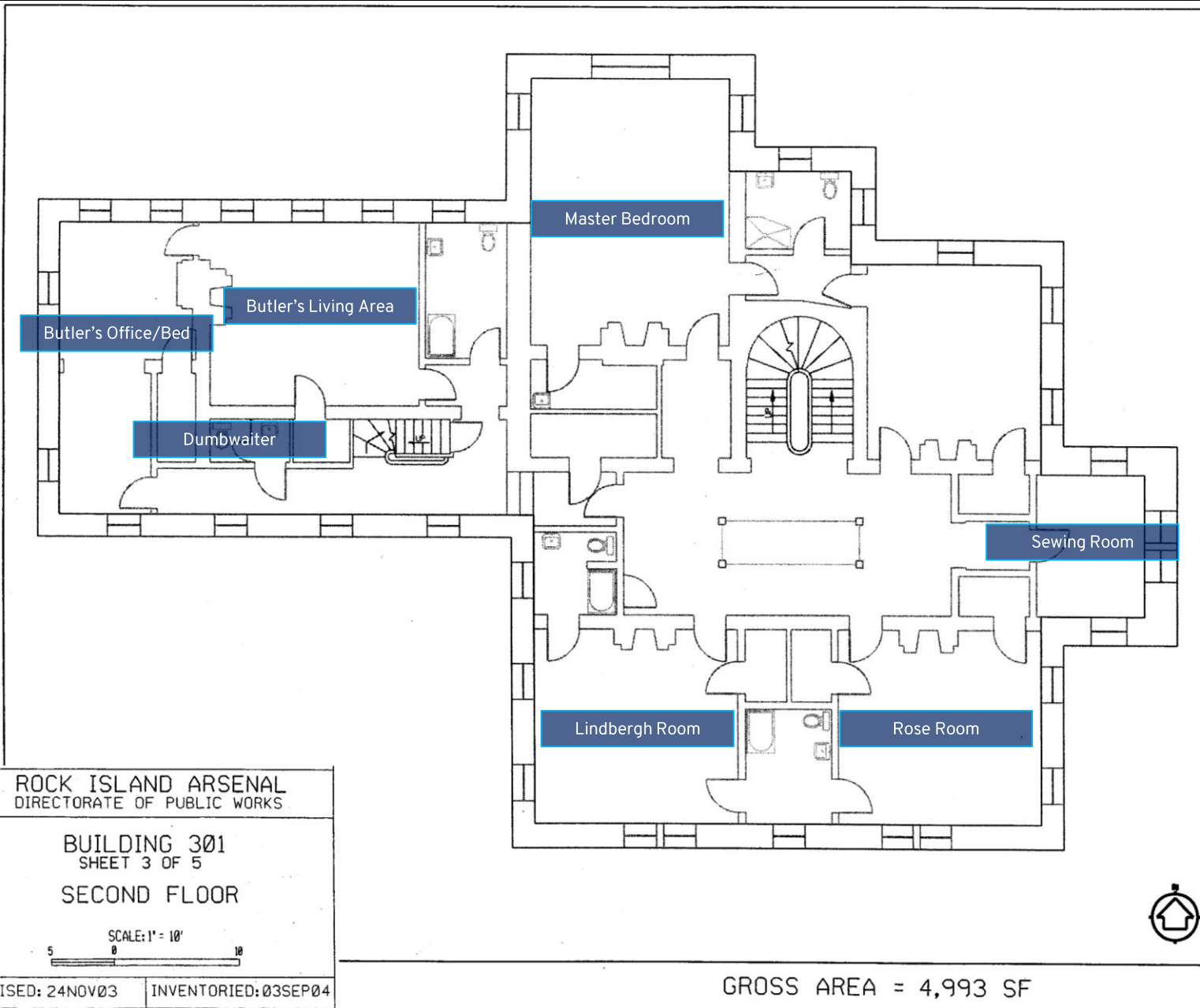

- Second floor front stairs are carpeted, rear is hard wood.
- Second floor front is original oak floors, rear is original birchwood.
- Bathroom on the southside is shared.
- North bathroom is joined by a hallway.
- Head Butler had his own living space and sleeping quarters.
- Due to changes in ceiling height between front and back of house, there are stairs to get to the back of the house.
- Charles Lindbergh had a brief stay in Quarters One if you couldn't tell...
- A few interesting tales on this floor – footsteps mainly.



QUARTERS ONE: THIRD FLOOR

1871

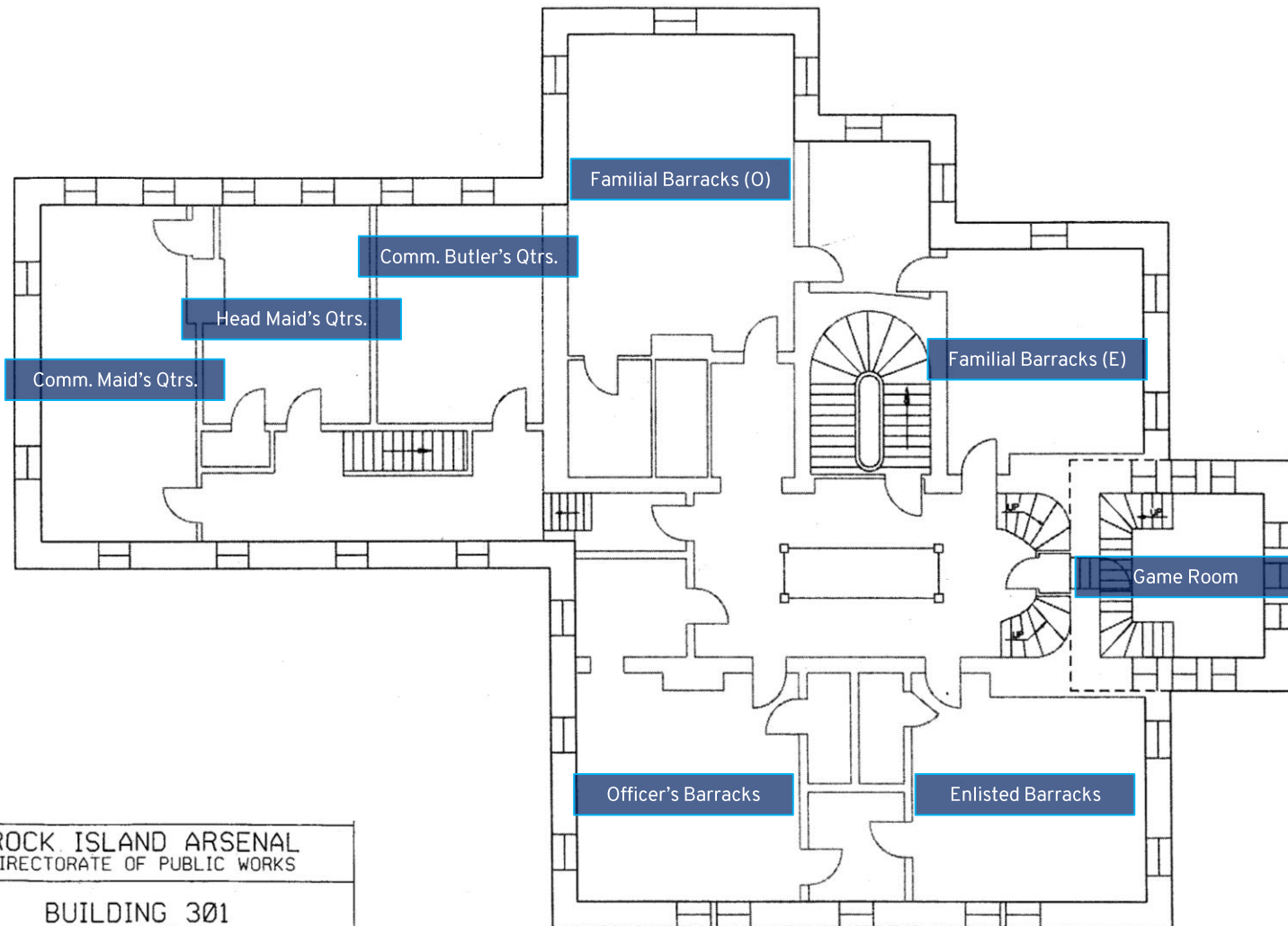

ROCK ISLAND ARSENAL
DIRECTORATE OF PUBLIC WORKS

BUILDING 301
SHEET 4 OF 5
THIRD FLOOR

SCALE: 1" = 10'
5 0 10

REVISED: 24NOV03 INVENTORIED: 03SEP04

GROSS AREA = 4,993 SF

- Third floor has raw birchwood floors with lead paint.
- Entirely designed as a barracks and housing for servants in the house.
- Has no heating nor cooling.
- Has no fireplaces.
- Ceilings are 9 feet all the way through.
- Has two access points to the roof plus a widows walk.
- Servants who were not head of the house had communal housing.
- Numerous stories on this floor.
- A few not-so-spooky tales as well.
- Area is now sealed off due to walking hazards and upkeep costs.



QUARTERS ONE: THE TOWER/ROOF

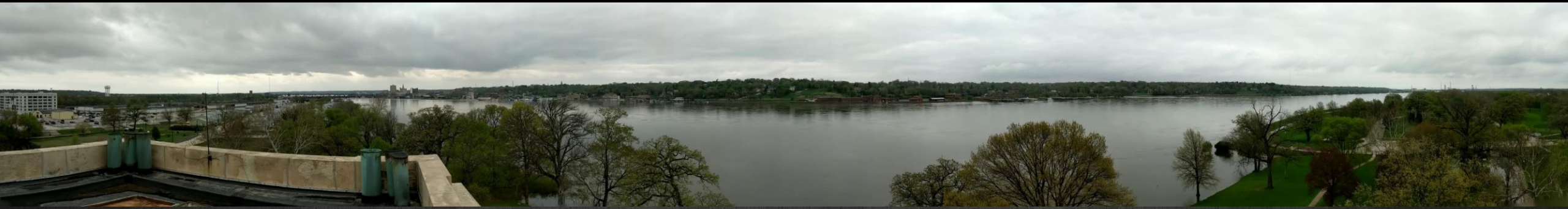

PANORAMA FROM QUARTERS ONE ROOF DURING THE GREAT 2019 FLOOD.

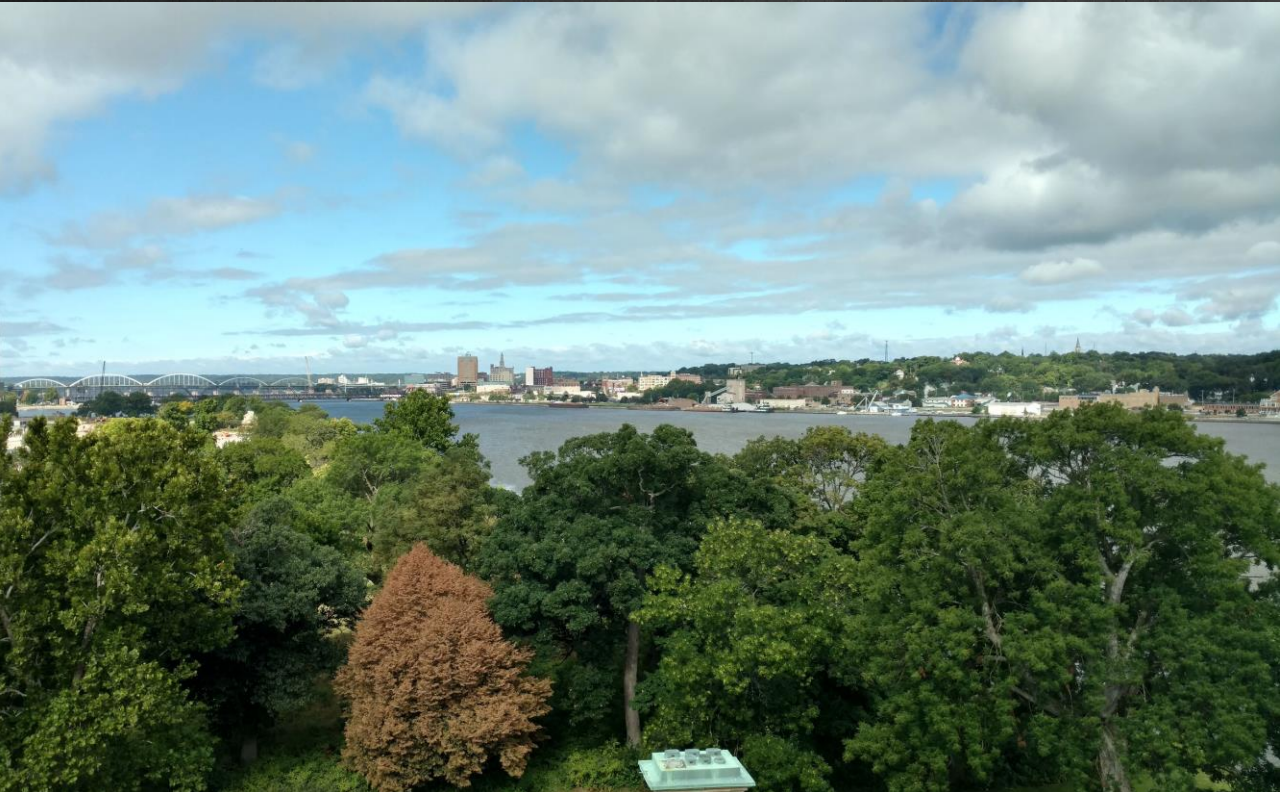

QUARTERS ONE ROOF LOOKING TOWARDS DAVENPORT



QUARTERS ONE ROOF LOOKING TOWARDS BETTENDORF